

200/EV5/450

Extended Roof Top Installation Instructions

STEP1

1. Install the Plug 25 × 25 onto both ends of the square tube
2. The Roof Support pole is installed on the Roof Support Assembly,R.
Do not tighten it until the roof is installed, then adjust the tightness
3. Installed Roof Support Assembly,F&R on the Frame Tube Assembly.
After installation, as shown in Figure ②

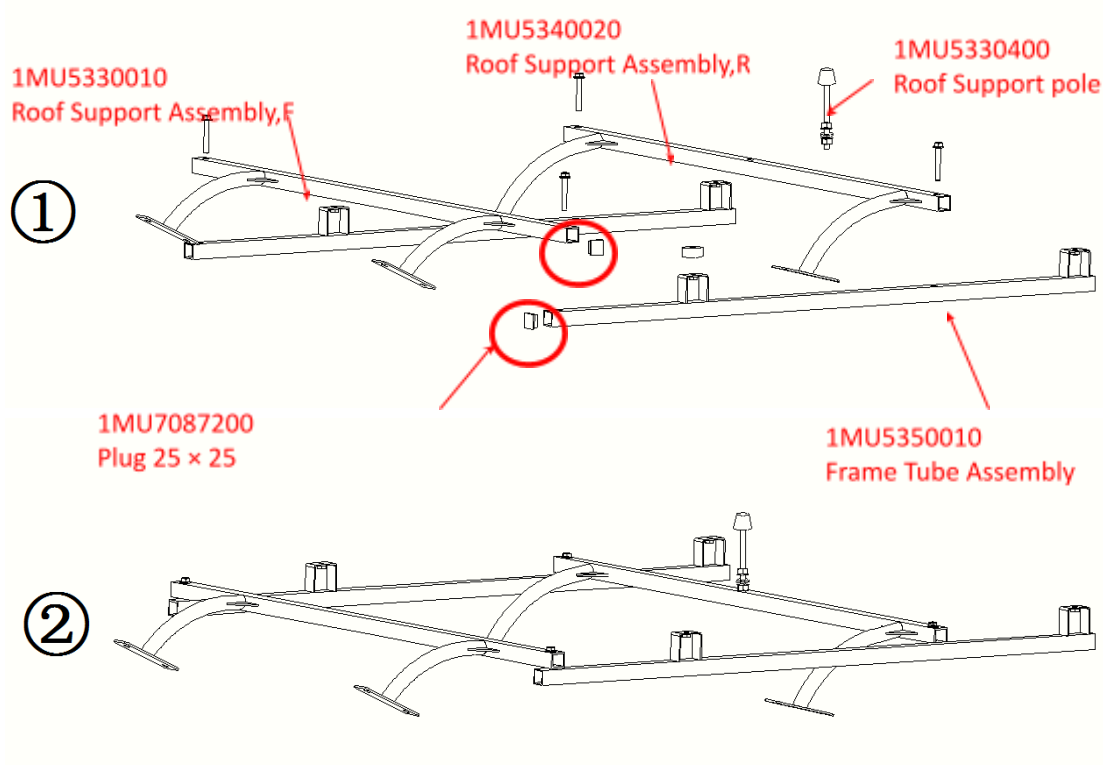

STEP2

1. Assemble the clamp and buffer rubber as shown in Figure 3
2. Install components from step 1 onto ROP rod,F/R, as shown in Figure 4

Attention: When installing Roof Support Assembly,F, the Z-shaped plate L/R needs to be installed together.

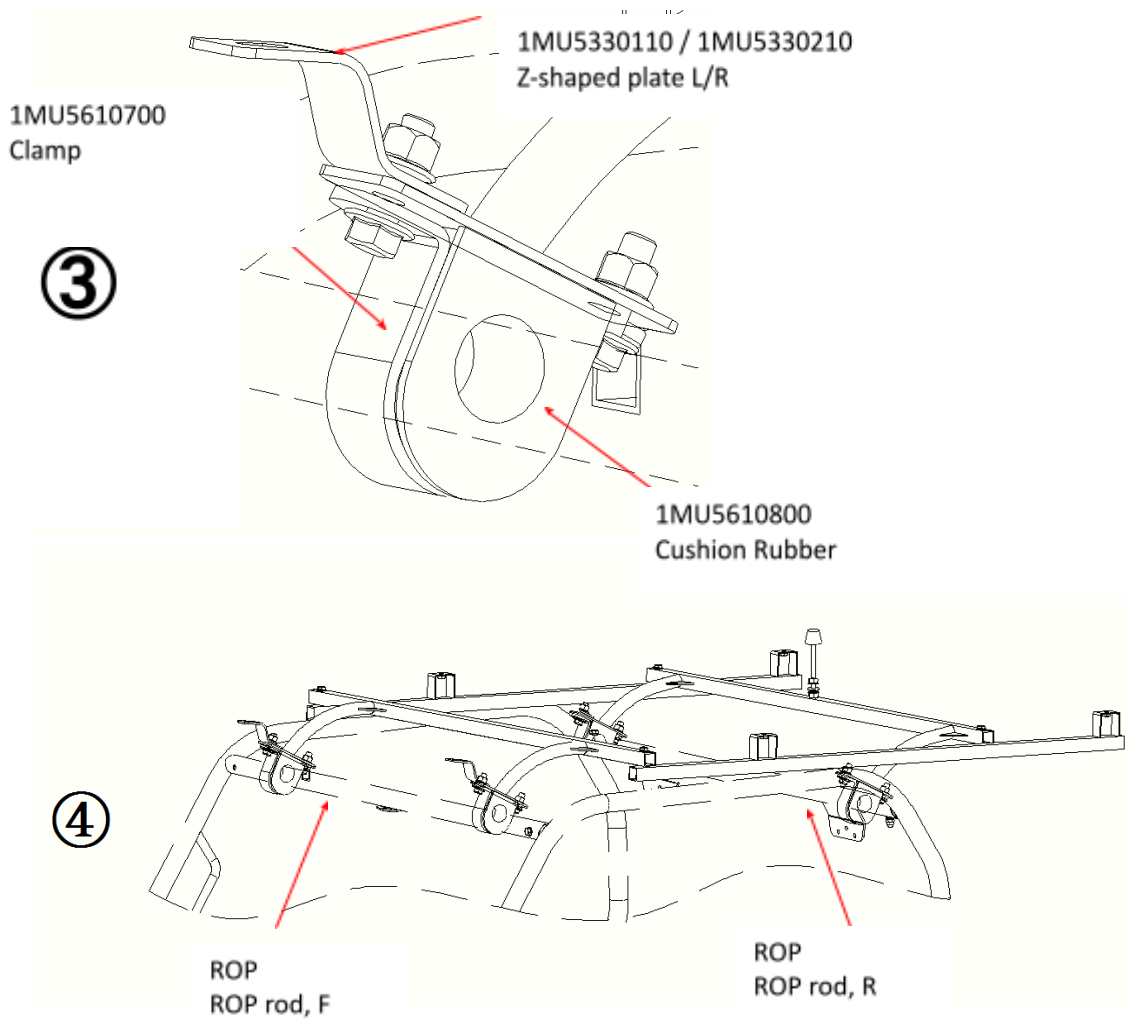

STEP3

1. Install the roof onto the roof bracket assembly, and place a rubber pad between the roof and bracket assembly, as shown in Figure ⑤
2. After installing the roof, adjust the tightness between the pole and the roof.

⑤

1MU5330300
Rubber Pad

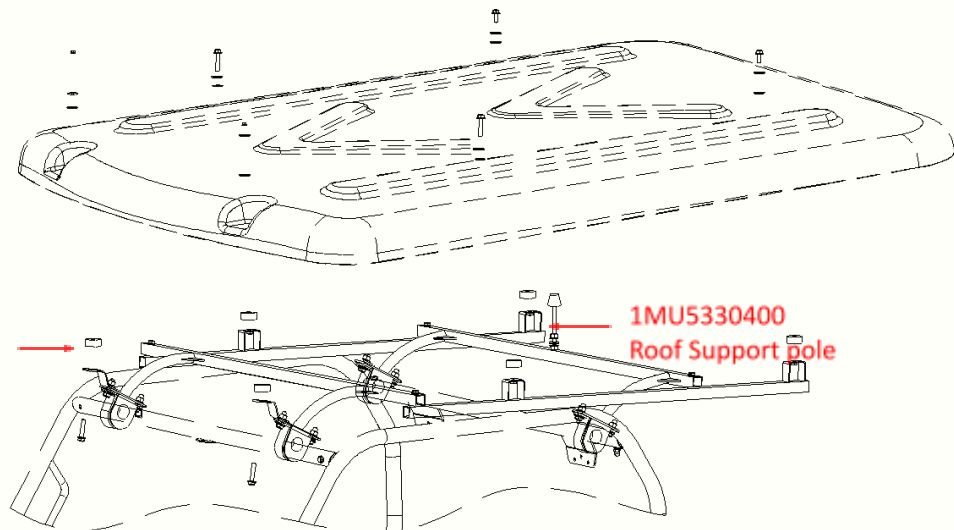

1MU5330400
Roof Support pole